

# S-Series StableSizer

Patents Issued and Applied for Worldwide

## TOTAL ELECTRICAL

27 KVA (Max.) 460V, 3 Ph  
7 KVA, 230V, 1 Ph (Heaters)

## STEAM

Saturated Steam Consumption:  
350 lbs/Hr @ 70-100 psig (482-689 kPa)  
(159 kg/Hr @ 655-784 kPa Absolute  
@ 158°C -170°C)

## AIR

80 psig Air Pressure (552 kPa)

## SPEED RANGE

5-50 YPM (4.5-45 m/m)

## OPERATING WIDTH "A"

S-80" Series: 76" Max. [1930mm]  
S-90" Series: 86" Max. [2184mm]  
S-100" Series: 96" Max. [2438mm]

## MACHINE WIDTH "B"

S-80" Series: 10'-4" [3149mm]  
S-90" Series: 11'-2" [3403mm]  
S-100" Series: 12'-0" [3657mm]

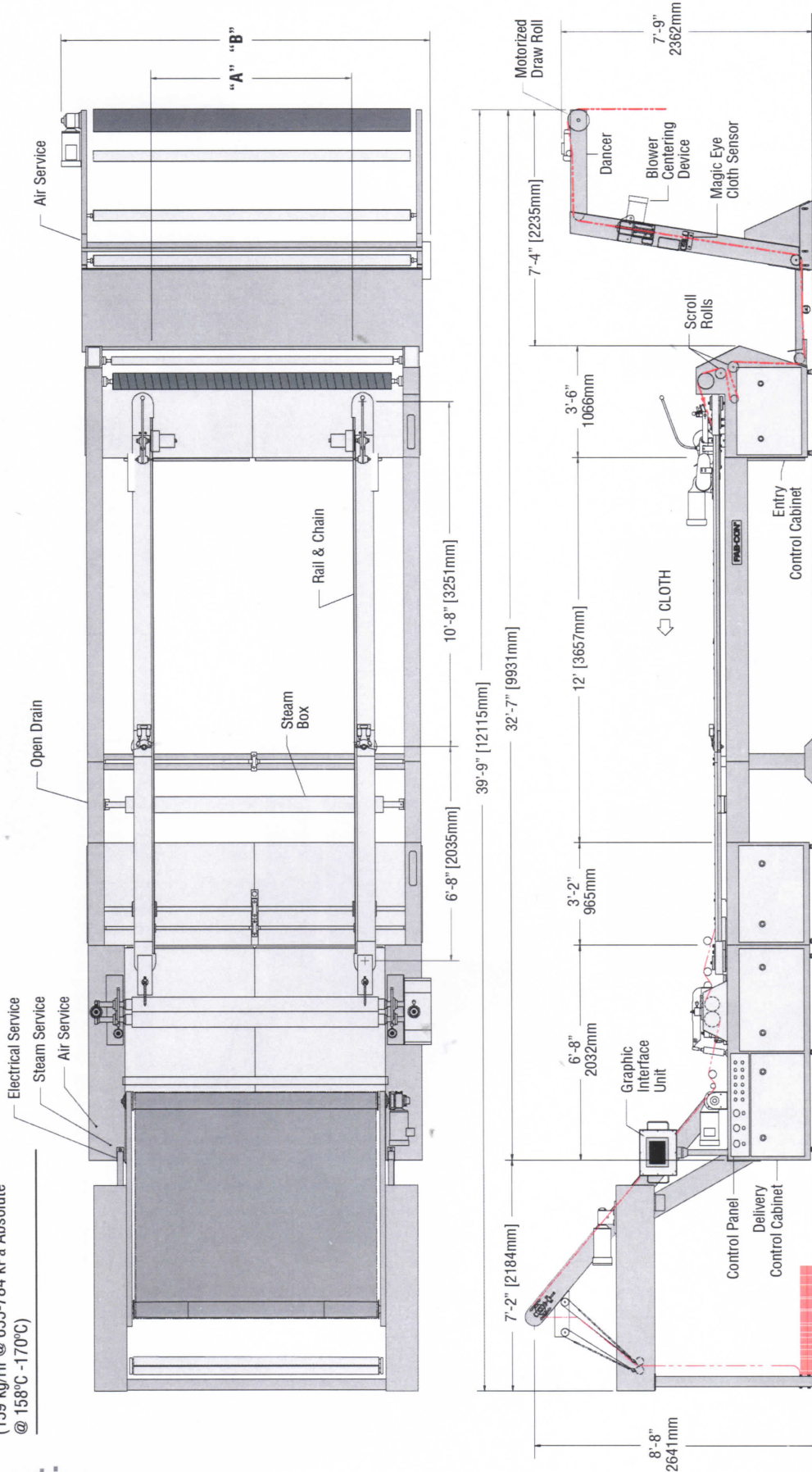

# Specifications

FOLDER

STABLESIZER

MINI-TENTER

CLOTH ENTRY

Design and specifications are subject to change without notice.



www.fab-con.com

P.O. BOX 591  
75 CHANNEL DRIVE  
PORT WASHINGTON, NY 11050-2216  
PHONE (00)1-516-883-3999  
FAX (00)1-516-883-3880  
E-MAIL: gullwingfc@aol.com